

MODEL B
SINGLE-ACTING, SPRING RETURN
HYDRAULIC CYLINDER
Max. Capacity: 103.1 Ton at 10,000 PSI



WARNING

To help avoid personal injury,

- Do NOT disassemble cylinder, the retainer nut is loaded with 300 lbs. spring force.
- All repairs MUST be done by a Power Team authorized Hydraulic Service Center.

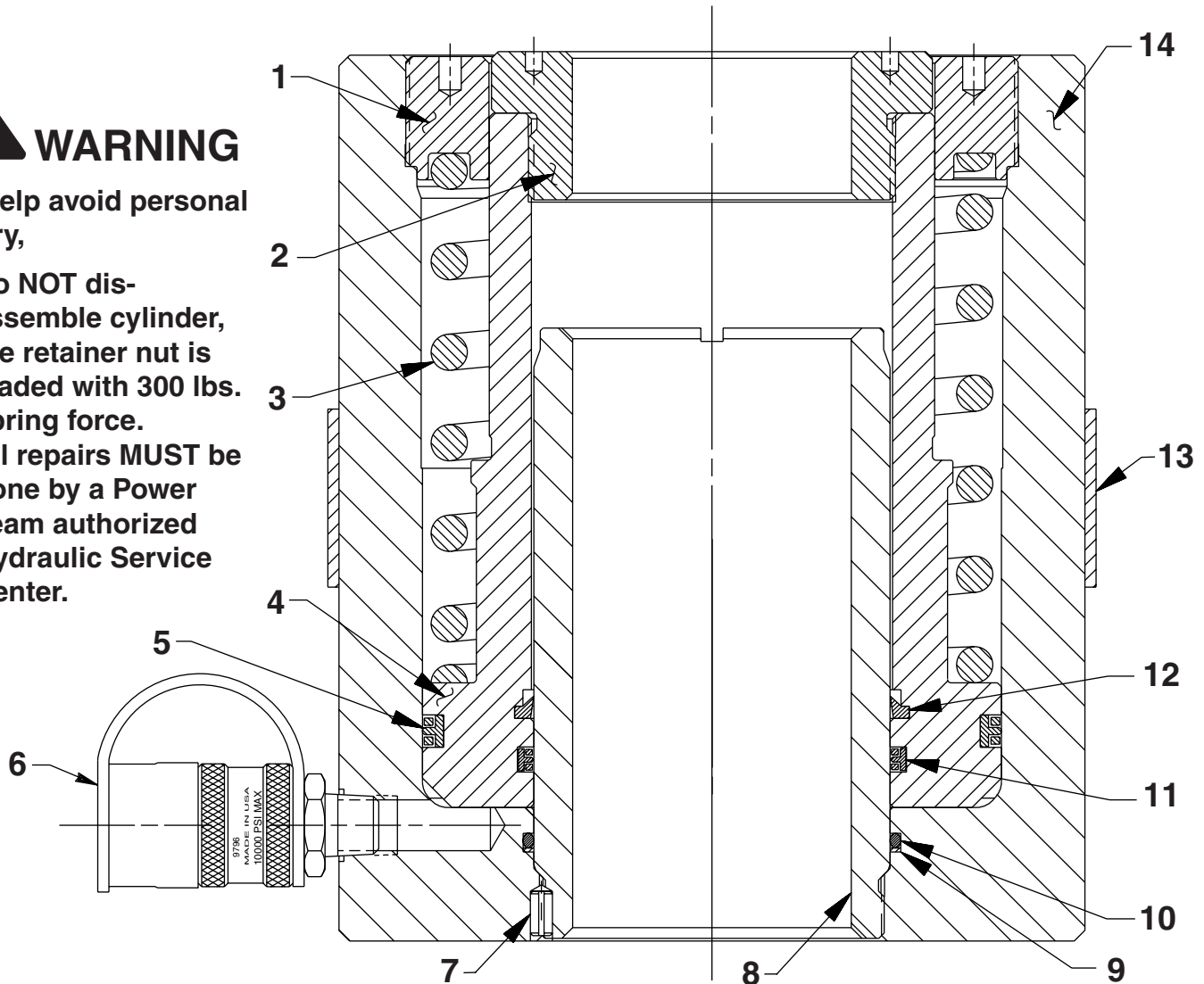

See **NOTE** on
back of sheet
1 of 1

Note: Shaded areas reflect last revision(s) made to this form.

Sheet No. 1 of 1

Rev. 1 Date: 22 Mar. 1999

Parts List, Form No. 101967, Back sheet 1 of 1

Item No.	Part No.	No. Req'd	Description
1	47055	1	Spring Retainer Nut (NOTE: Loaded with 300 lbs. spring force.)
2	308240	1	Plain Insert
3	214499	1	Spring
4	53068	1	Piston
5	*214495	1	T-seal with Backup Rings (Smooth side of Backup Ring must be against Seal.)
6	9796	1	Coupler
7	†15566	1	Roll Pin (See NOTE below)
8	47054	1	Cylinder Standpipe
9	†19331	1	Backup Washer
10	12599	1	O-ring
11	*214496	1	T-seal with Backup Rings (Smooth side of Backup Ring must be against seal.)
12	*214497	1	Rod Wiper
13	421794OR9	1	Cylinder Lift Handle
14	65947	1	Cylinder Body



PARTS INCLUDED BUT NOT SHOWN

*203908	1	Warning Decal
351821	1	Trade Name Decal

Part numbers marked with an asterisk (*) are contained in Standard Repair Kit No. 300485.
Part numbers marked with a dagger (†) are contained in Viton Seal Kit No. 300585.

NOTE: Cylinders built after 1-1-99 do not use this roll pin to lock the standpipe and cylinder body together. Loctite 242 is used on last 2-3 standpipe threads only!



WARNING: To help avoid personal injury,

- Do NOT disassemble cylinder, the retainer nut is loaded with 300 lbs. spring force.
- All repair MUST be done by a Power Team authorized Hydraulic Service Center.

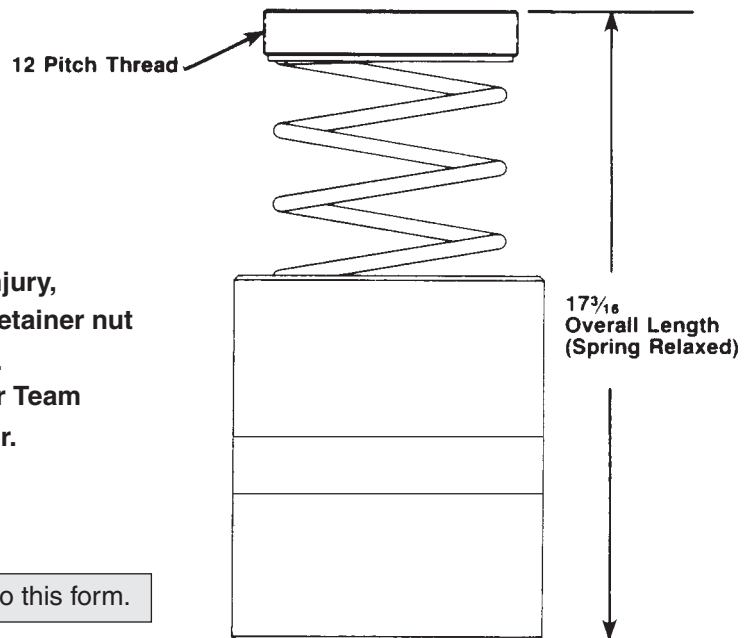

Note: Shaded areas reflect last revision(s) made to this form.

Refer to any operating instructions included with this product for detailed information about operation, testing, disassembly, reassembly, and preventive maintenance.

Items found in this parts list have been carefully tested and selected. **Therefore: Use only genuine Power Team replacement parts!**

Additional questions can be directed to our Technical Services Department.