

**MODEL B  
PISTON ACCUMULATOR  
5,000 PSI Max. Operating Pressure**

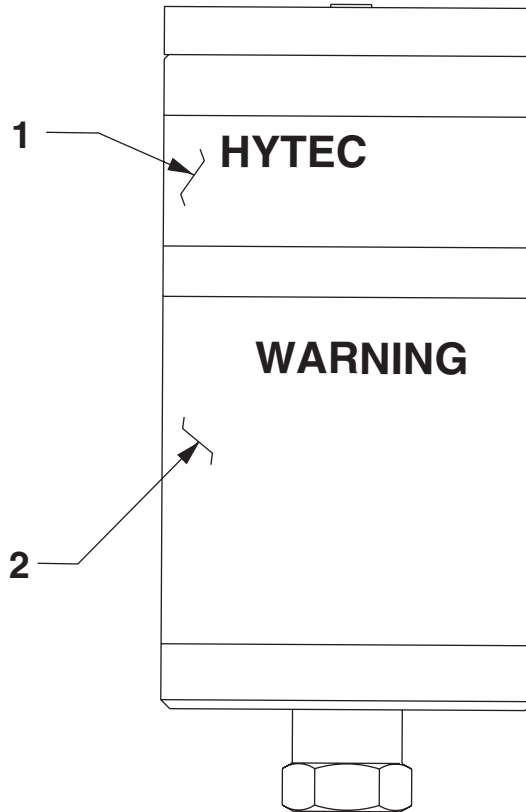

Item No.	Part No.	No. Req'd	Description
1	351474	1	Trade Name Decal (For 100138)
	351475	1	Trade Name Decal (For 100222)
	351457	1	Trade Name Decal (For 100982)
	351458	1	Trade Name Decal (For 100983)
2	350173	1	Warning Decal

**Note: All accumulators are shipped with a metering valve**

#252586 (For 100982 & 100983)

or #251827 (For 100138 & 100222)

**A parts breakdown of these metering valves are shown on back page 1 of 2.**

Refer to "Maintenance Section" on sheet 2 of 2 for a detail of the accumulator seals available in Repair Kit No. 300591.

Note: Shaded areas reflect last revision(s) made to this form.

Sheet No. 1 of 2

Rev. 2 Date: 23 Sept. 1999

### METERING VALVE

#252586

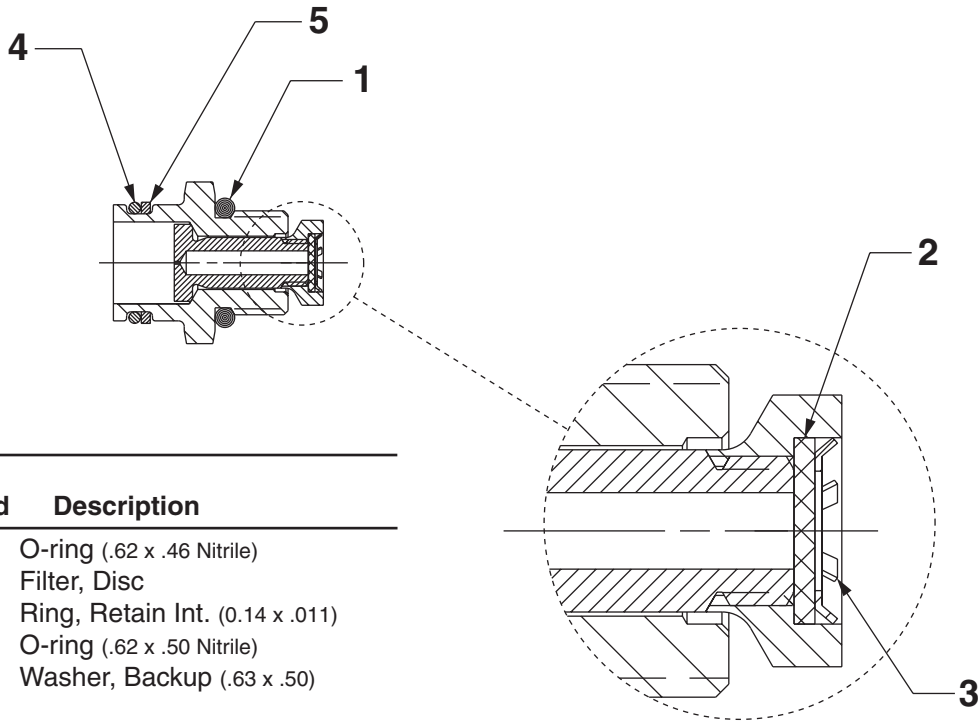

Item No.	Part No.	No. Req'd	Description
1	10300	1	O-ring (.62 x .46 Nitrile)
2	212756	1	Filter, Disc
3	12041	1	Ring, Retain Int. (0.14 x .011)
4	10301	1	O-ring (.62 x .50 Nitrile)
5	12390	1	Washer, Backup (.63 x .50)

Note: No seating required. Poppet will seat itself.

### METERING VALVE

#251827

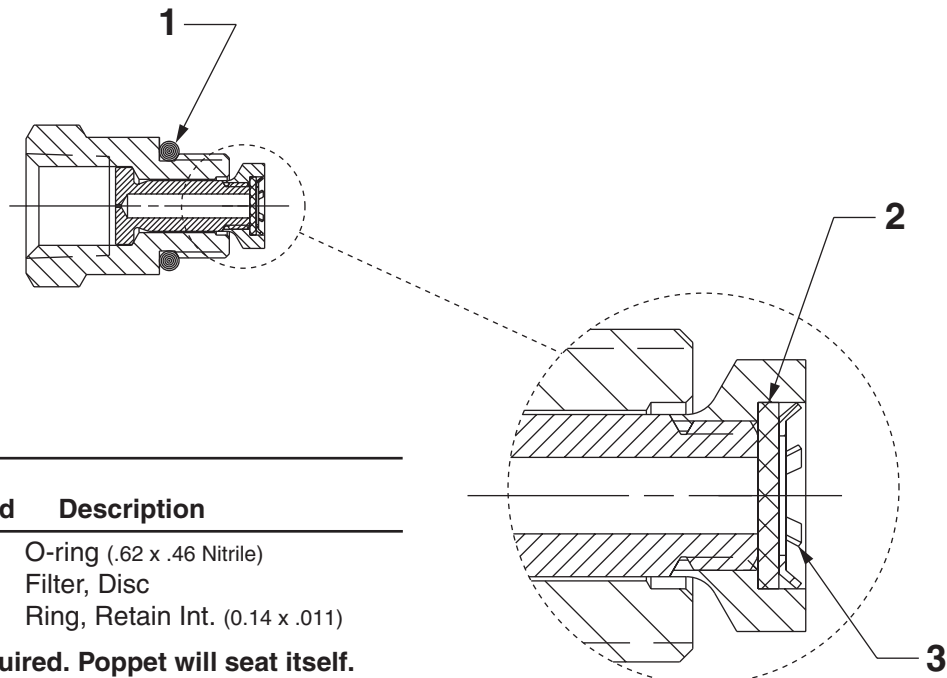

Item No.	Part No.	No. Req'd	Description
1	10300	1	O-ring (.62 x .46 Nitrile)
2	212756	1	Filter, Disc
3	12041	1	Ring, Retain Int. (0.14 x .011)

Note: No seating required. Poppet will seat itself.

## MAINTENANCE

Refer to Figure 1.

### Removing Accumulator from System

Open control valve or system bypass valve to relieve fluid pressure to 0 PSI. Remove accumulator and drain.

### Disassembly of Accumulator

1. Place accumulator on bench in clean, dust-free area.
2. Remove cap from gas valve.
3. Carefully turn the gas valve swivel nut counterclockwise to relieve accumulator pre-charge pressure. Loosen the swivel nut slowly to govern rate of discharge of gas.
4. When pre-charge pressure is 0 PSI remove the gas valve from air end plug.
5. Apply shop air to move piston against end plug.
6. Remove threaded end plug from cylinder with spanner wrench.
7. Remove piston.

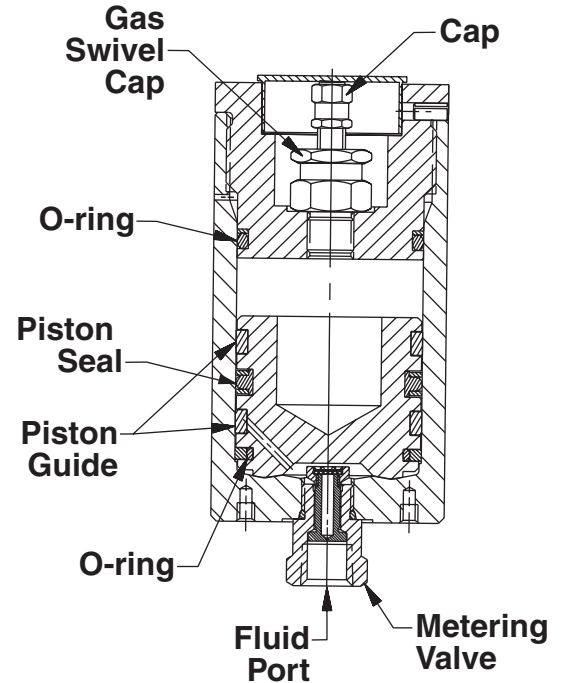

FIGURE 1

### Inspecting the Accumulator for Damage

1. Check gas valve for any sign of damage to metal-to-metal seat.
2. Examine valve o-ring for signs of damage or wear.
3. Clean all metal parts with an approved cleaning solvent and dry prior to reassembly. **IMPORTANT: Cylinder bore, end caps and piston should be free of surface damage and foreign matter prior to reassembly.**

Repair Kit No. 300591 is available for replacement of all accumulator seals.

### Reassembly of Accumulator

1. Wet seal with system fluid and assemble into piston groove. Seal must not be twisted when placed in groove.
2. Lubricate guides and seat in piston groove.
3. Apply system fluid on seal, guides and cylinder wall.
4. Avoid cocking the piston while carefully assembling piston into cylinder. It may be necessary to lightly tap the piston with a soft head mallet. Be careful not to damage the seals!
5. Assemble o-ring into end plug groove.
6. Apply clean grease (molycote 55M) over o-ring and thread end plug into cylinder.
7. Lubricate gas valve o-ring with clean hydraulic oil prior to installation into end plug. Clean sealing surfaces and examine for any nicks or scratches before installing gas valve. Torque bottom nut against face of end plug to 100/110 in. lbs.

**IMPORTANT: Never loosen the bottom nut for discharge of gas pressure. This nut should always remain tight against the face of end plug.**

## ACCUMULATOR ASSEMBLY

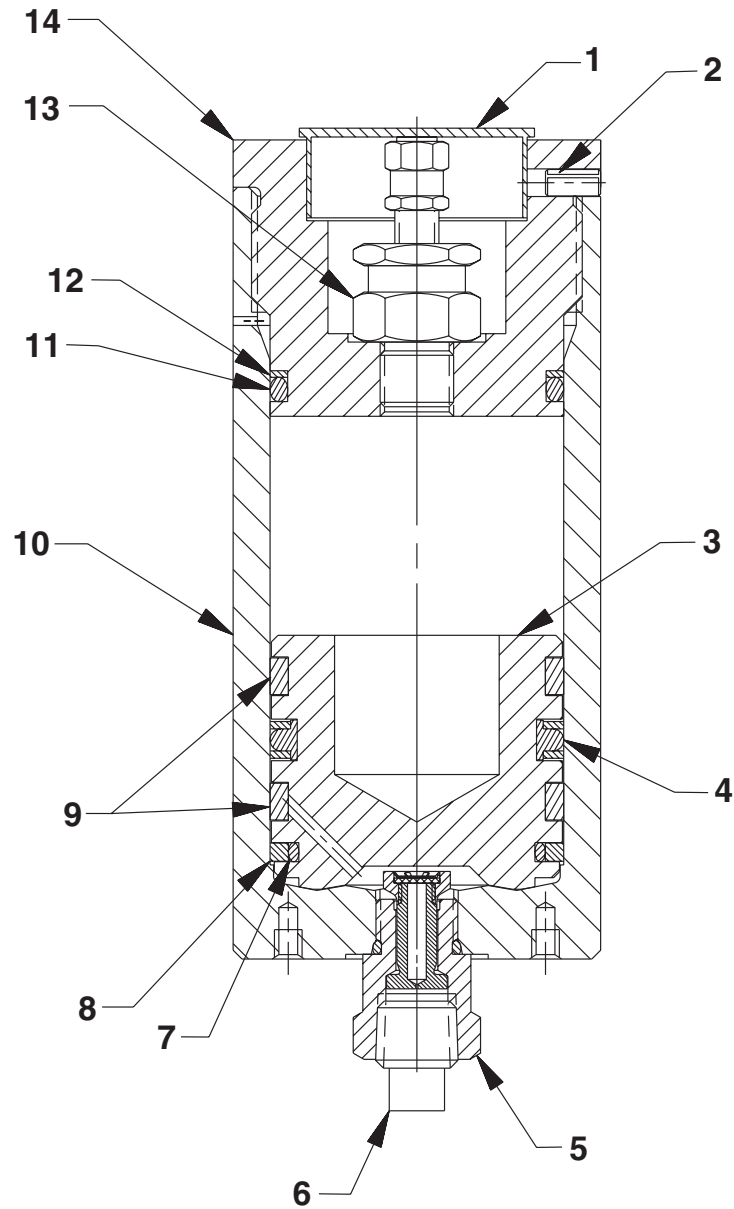

Item No.	Part No.	No. Req'd	Description
1	<b>252605</b>	1	Cap, Plastic
2	<b>250622</b>	1	Pin, Spring
3	<b>351449</b>	1	Piston
4	<b>*15168</b>	1	T-seal (2.00 x 1.63 x .27 L)
5	<b>251827</b>	1	Valve, Metering (Torque to 170/200 in. lbs.; For 100138 & 100222)
	<b>252586</b>	1	Valve, Metering (Torque to 170/200 in. lbs.; For 100982 & 100983)
6	<b>10970</b>	1	Fitting, Plug (1/4 NPTF)
7	<b>*252589</b>	1	O-ring (1.81 x 1.54 x .10)
8	<b>*252587</b>	1	Ring, Piston (2.0 x 1.75 x .12)

Item No.	Part No.	No. Req'd	Description
9	<b>*252588</b>	2	Seal, Wear (2.0 x 1.75)
10	<b>58935</b>	1	Body, Cylinder (For 100138 & 100982)
	<b>58947</b>	1	Body, Cylinder (For 100222 & 100983)
11	<b>*10294</b>	1	O-ring (2.00 x 1.75 Nitrile)
12	<b>*19145</b>	1	Washer, Backup (2.00 x 1.75)
13	<b>252590</b>	1	Valve, Compressed Gas (Torque to 100/110 in. lbs.)
14	<b>421501</b>	1	Cap, End

Part numbers marked with an asterisk (\*) are contained in Repair Kit No. 300591.