

Manifold Mounted Control Valve

SPX HYTEC



Similar to Hytec's 100969 and 100970, this 3-way/4-way, two-position directional control valve is ideal for manifold mounting on your fixture. The valve's zero-leakage design is the right choice for constant pressure applications. Its smaller size allows you to maximize usable fixture space.

This valve is designed with a standard ANSI, DO3 mounting and port configuration. The control lever can be placed in any of 24 positions without tools. Infinite adjustments are possible by loosening a locknut. Internal stops and detents along with a shaft wiper seal provide excellent contamination resistance.

Built without check valves, this valve is intended **only** for systems with one valve per

hydraulic pressure source. For multiple valve applications, simply add the 100974 check valve sub-plate. Ported subplates 100972 and 100973 or manifold 100975 can also be added as appropriate.

Features:

- 3-way/4-way, 2-position, detented
- ANSI, DO3 mounting configuration
- Single or double acting systems
- Manually operated, 90 deg. swing
- 1500 psi max. return line pressure
- Optional SAE or NPT ported subplates
- Infinite handle adjustment
- 5,000 psi max.
- Shaft wiper excludes contaminants
- Optional check-valve subplate

Manifold Mounted Control Valve

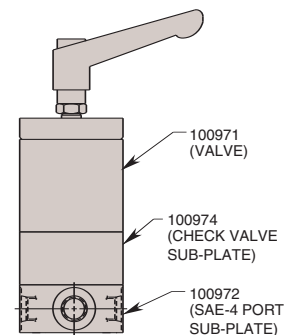
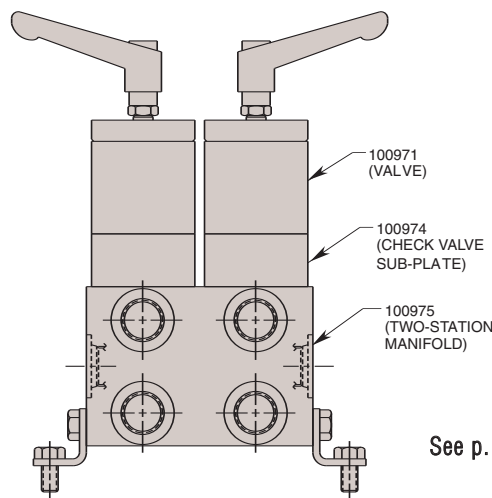
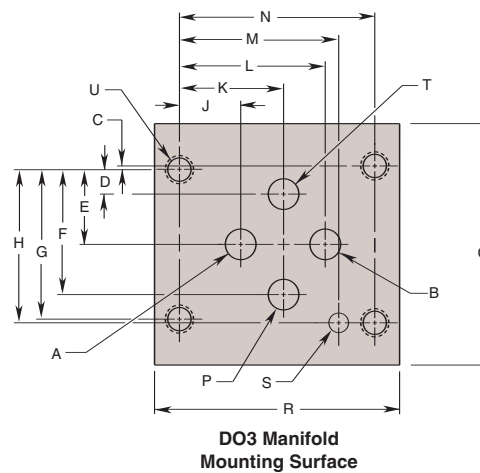
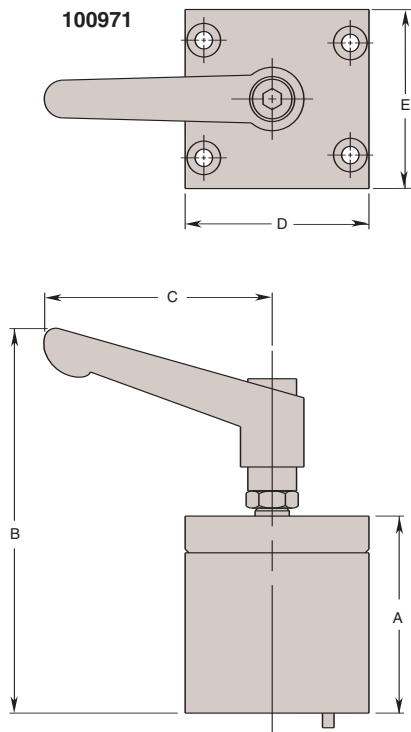

Cat. No.	Dimensions (In Inches)				
	A	B	C Rad.	D	E
100971	2.144	4.187	2.480	2.000	1.948

#10-24UNC X 2.25 Lg. Mounting screws (4) Included.

See p. 98 for sub-plates and manifolds.

DO3 Mounting Pattern	Dimensions (In Inches)																		
	"A" Port Dia. Max	"B" Port Dia. Max	C	D	E	F	G	H	J	K	L	M	N	"P" Port Dia. Max.	Q Min.	R Min.	† S Dia.	"T" Port Dia. Max.	†† U Thread Size
	.250	.250	.030	.200	.610	1.020	1.220	1.250	.500	.850	1.190	1.300	1.594	.250	1.970	2.000	.160	.250	10-24 UNC

NOTE: † Location hole to be .160 deep min.
†† Minimum thread depth .200