

Cross
Compression Tube

Cat. No.	Dimensions (In Inches)				
	A	B	C	D	E Tube Size
15058	2.156	1.078	.750	.750	.250
17278	2.781	1.391	.953	.750	.375

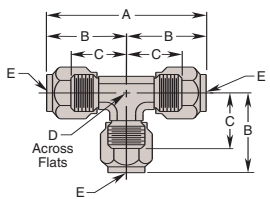

Union Tee
Compression Tube

Cat. No.	Dimensions (In Inches)				
	A	B	C	D	E Tube Size
15054	2.156	1.078	.750	.438	.250
10659	2.844	1.422	.984	.625	.375

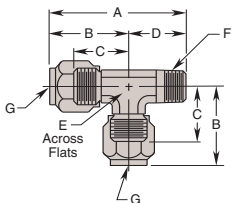

Male Run Tee
Compression Tube to NPTF

Cat. No.	Dimensions (In Inches)						
	A	B	C	D	E	F Thread Size	G Tube Size
15050	1.859	1.078	.750	.781	.438	1/8 NPTF	.250
205791	2.047	1.109	.781	.938	.500	1/4 NPTF	.250
10669	2.484	1.422	.984	1.062	.625	1/4 NPTF	.375

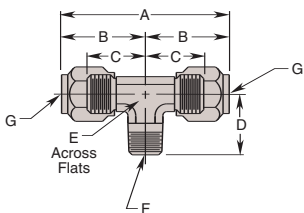

Male Branch Tee
Compression Tube to NPTF

Cat. No.	Dimensions (In Inches)						
	A	B	C	D	E	F Thread Size	G Tube Size
15055	2.156	1.078	.750	.781	.438	1/8 NPTF	.250
205790	2.219	1.109	.781	.938	.500	1/4 NPTF	.250
10670	2.844	1.422	.984	1.062	.625	1/4 NPTF	.375

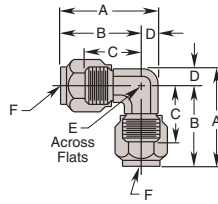

90° Male Elbow
Compression Tube

Cat. No.	Dimensions (In Inches)					
	A	B	C	D	E	F Tube Size
15059	1.297	1.078	.750	.219	.438	.250
250211	1.641	1.359	.922	.281	.562	.375

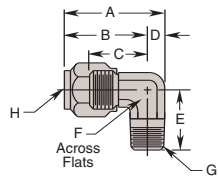

90° Male Elbow
Compression Tube to NPTF

Cat. No.	Dimensions (In Inches)							
	A	B	C	D	E	F	G Thread Size	H Tube Size
15052	1.297	1.078	.750	.219	.781	.438	1/8 NPTF	.250
205792	1.484	1.203	.875	.281	1.062	.562	1/4 NPTF	.250
10665	1.641	1.359	.922	.281	1.094	.562	1/4 NPTF	.375

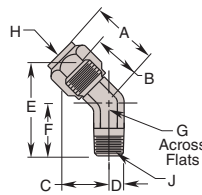

45° Male Elbow
Compression Tube to NPTF

Cat. No.	Dimensions (In Inches)									
	A	B	C	D	E	F	G	H Tube Size	J Thd. Size	
15053	.953	.625	.672	.281	1.359	.688	.562	.250	1/8 NPTF	
10655	1.234	.797	.828	.281	1.708	.875	.562	.375	1/4 NPTF	

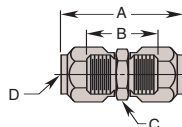

Male Union
Compression Tube

Cat. No.	Dimensions (In Inches)			
	A	B	C Hex.	D Tube Size
15060	1.562	.906	.500	.250
250212	1.875	1.000	.625	.375

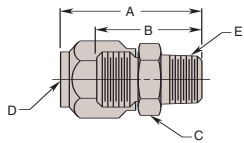

Male Connector
Compression Tube to NPTF

Cat. No.	Dimensions (In Inches)				
	A	B	C Hex.	D Tube Size	E Thread Size
15061	1.281	.953	.500	.250	1/8 NPTF
205793	1.484	1.156	.625	.250	1/4 NPTF
10661	1.641	1.203	.625	.375	1/4 NPTF

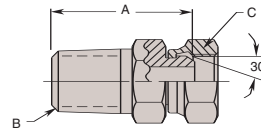

Swivel Adapter

Caution - The female swivel end is a straight pipe thread (NPSM) with a 30° seat. All male pipe fittings that are used with these female swivel adapters must have an internal 30° seat to seal properly.

Cat. No.	Dimensions (In Inches)		
	A	B Thread Size	C Thread Size
15069	1.030	1/4 NPTF	1/8 NPSM
11310	1.260	1/4 NPTF	1/4 NPSM

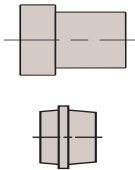

Tube Sleeve

Cat. No.	A Tube Size	Fitting Style
13031	.250	Compression
10430	.375	

NOTE: Hytec tube sleeves may not be compatible with other tubing materials and grades.

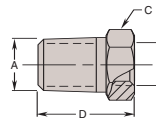

Reducer
NPTF

Cat. No.	Dimensions (In Inches)			
	A Thread Size	B Thread Size	C Hex.	D
13269	1/4 NPTF	1/8 NPTF	.625	.781

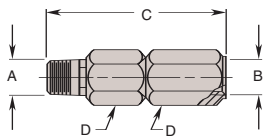

Check Valve

Cat. No.	Dimensions (In Inches)			
	A Thread Size	B Thread Size	C	D Hex.
206330	1/4 NPTF	1/4 NPTF	2.250	.750

NOTE: Cracking pressure - 5 psi max.

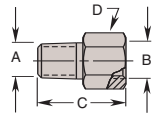

Adapter
NPTF

Cat. No.	Dimensions (In Inches)			
	A Thread Size	B Thread Size	C	D Hex.
15235	1/8 NPTF	1/4 NPTF	1.140	.750
*252128	1/4 NPTF	7/16 20UNF SAE-4	1.310	.688

* Use with 216437 Metering Valve to control flow in 1/4 NPTF actuators.

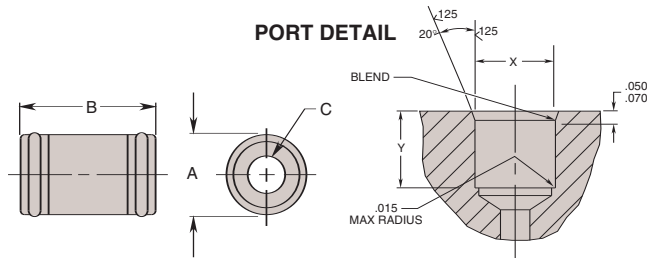

Connector Bushing

Cat. No.	Dimensions (In Inches)				
	Bushing			Port	
	A Dia.	B	C Dia.	X Dia.	Y
*100169	.500	.844	.234	.500 .503	.515 .535

NOTE: * Box of Ten Connector Bushings.

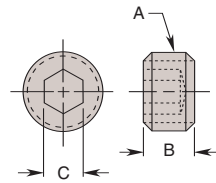

Plug
NPTF

Cat. No.	PLUGS - NPTF		
	Dimensions (In Inches)		
	A Thread Size	B	C Hex.
15499	1/8 NPTF	.242	.188
10479	1/4 NPTF	.437	.250
16232	3/8 NPTF	.400	.312

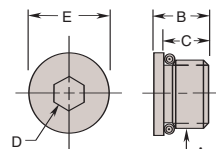

Plug
SAE O-Ring

Cat. No.	PLUGS - SAE O-RING				
	Dimensions (In Inches)				
	A Thread Size	B	C	D Hex.	E Dia.
250883	7/16-20UNF SAE-4	.450	.360	.188	.563

Connector
NPTF

Cat. No.	Dimensions (In Inches)				
	A Thread Size	B Thread Size	C Hex.	D Dia.	E
12740	1/4 NPTF	1/4 NPTF	.750	.730	1.125

Male Branch Tee
Compression Tube to O.R.B.

Cat. No.	Dimensions (In Inches)						
	A	B	C	D	E	F Thread Size	G Tube Size
250689	2.156	1.078	.750	1.047	.438	7/16-20 UNF SAE-4	.250

Metering Valve
NPTF to O.R.B.

Cat. No.	Dimensions (In Inches)					
	A Thread Size	B Thread Size	C Hex.	D	E	F
216437	7/16-20UNF SAE-4	1/4 NPTF	.750	.700	.435	.075

NOTE: Orifice size - .013/.017 dia.

90° Swivel Adapter

Caution - The female swivel end is a straight pipe thread (NPSM) with a 30° seat. All male pipe fittings that are used with these female swivel adapters must have an internal 30° seat to seal properly.

Cat. No.	Dimensions (In Inches)			
	A Thread Size	B Thread Size	C	D
250692	7/16-20 UNF SAE-4	1/4 NPSM	1.120	.970

Male Connector
O.R.B. to Compression Tube

Cat. No.	Dimensions (In Inches)					
	A Thread Size	B	C	D Hex.	E	F Tube Size
250685	7/16-20 UNF SAE-4	1.203	.875	.562	.359	.250
250686	9/16-18 UNF SAE-6	1.453	1.016	.812	.391	.375

Male Adapter
O.R.B. to NPTF

Cat. No.	Dimensions (In Inches)				
	A Thread Size	B Thread Size	C	D Hex.	E
210312	7/16-20 UNF SAE-4	1/4 NPTF	1.062	.750	.710

90° Male Elbow
Compression Tube to O.R.B.

Cat. No.	Dimensions (In Inches)								
	A	B	C	D	E	F	G	H Thread Size	J Tube Size
250687	1.297	1.078	.219	.750	1.266	1.078	.438	7/16-20 UNF SAE-4	.250
250688	1.625	1.344	.281	.906	1.516	1.250	.562	9/16-18 UNF SAE-6	.375

Swivel Adapter

Caution - The female swivel end is a straight pipe thread (NPSM) with a 30° seat. All male pipe fittings that are used with these female swivel adapters must have an internal 30° seat to seal properly.

Cat. No.	Dimensions (In Inches)			
	A Thread Size	B Thread Size	C	D
250690	7/16-20 UNF SAE-4	1/4 NPSM	1.320	.865

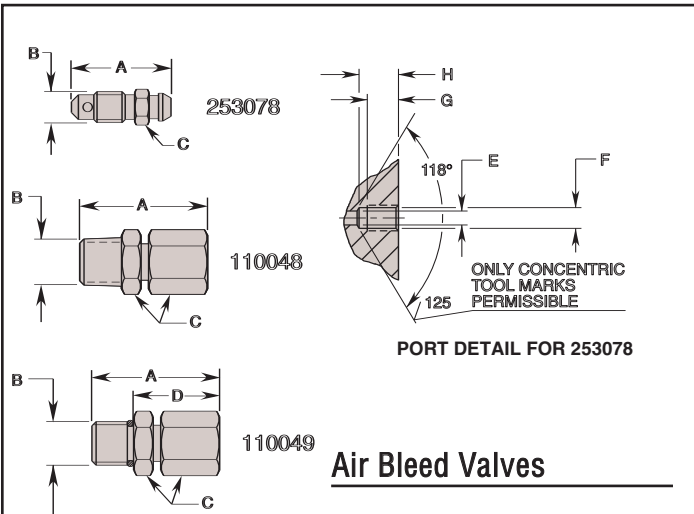

Air Bleed Valves

Cat. No.	Dimensions (In Inches)							
	A	B Thread Size	C Hex	D	E Dia. Max.	F Thread Size	G Min.	H
253078	1.000	3/16-24UNF	.312	-	.177	3/16-24UNF	.350	.450 .510
110048	1.630	1/4 NPTF	.562	-	-	-	-	-
110049	1.440	3/16-20UNF SAE-4	.562	1.080	-	-	-	-

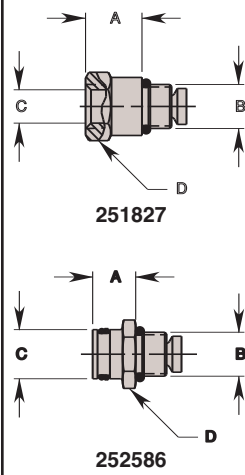

Accumulator Metering Valves

Cat. No.	Dimensions (In Inches)				
	A	B Thd. Size	C Thd. Dia.		D Hex
251827	.698	3/16-18 UNF	1/4 NPT		.750
252586	.544		.624 .622		

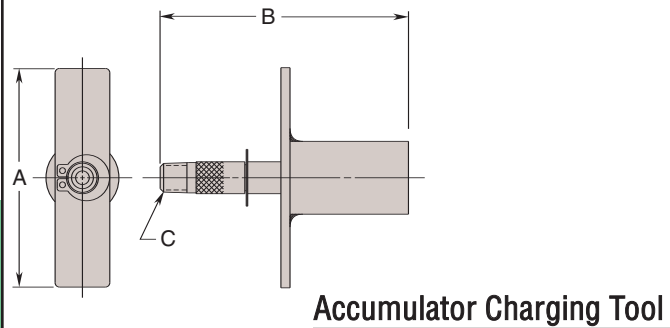

Accumulator Charging Tool

Cat. No.	Dimension (In Inches)		
	A	B	C Thread Size
500149	3.000	3.400	1/8 NPTF

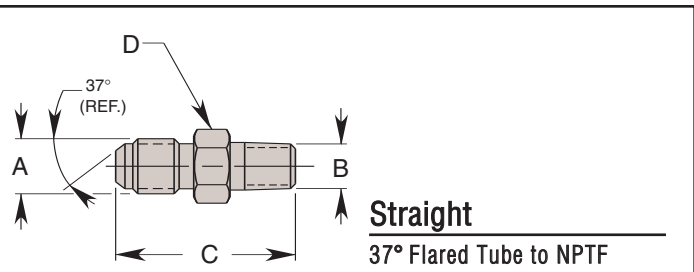

Straight
37° Flared Tube to NPTF

Cat. No.	Dimensions (In Inches)				
	A Thd. Size	B Thd. Size	C	D Hex	Tube Dia.
11628	3/16-18 UNF	3/8 NPTF	1.430	.750	.375
253019	3/16-20 UNF	1/4 NPTF	1.220	.500	.250
253076	3/16-18 UNF	1/4 NPTF	1.420	.562	.375
253174			1.430	.625	

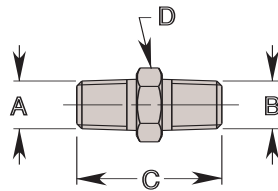

Straight
NPTF

Cat. No.	Dimensions (In Inches)			
	A Thd. Size	B Thd Size	C	D Hex
10672	1/4 NPTF	1/4 NPTF	1.450	.625
11421	1/4 NPTF	1/4 NPTF	1.060	.437
12328	3/8 NPTF	1/4 NPTF	1.360	.750
16691	1/4 NPTF	1/4 NPTF	1.234	.593
215373	1/4 NPTF	3/8 NPTF	1.010	.438

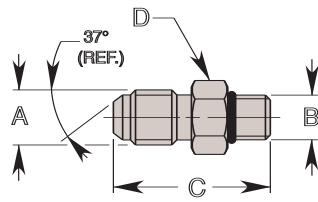

Straight
37° Flared Tube to O.R.B.

Cat. No.	Dimensions (In Inches)				
	A Thd. Size	B Thd Size	C	D Hex	Tube Dia.
253020	3/16-20 UNF	3/16-20 UNF SAE-4	1.230	.562	.250
253021	3/16-18 UNF	3/16-18 UNF SAE-6	1.300	.687	.375

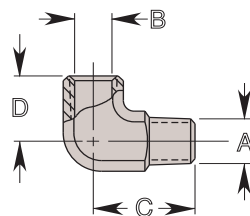

90° Elbow Adapter
NPTF

Cat. No.	Dimensions (In Inches)			
	A Thd. Size	B Thd Size	C	D
10617	1/4 NPTF	1/4 NPTF	1.090	.880
13229	1/4 NPTF	1/4 NPTF	.780	.660
13864		1/4 NPTF		.880

90° Male Elbow
37° Flared Tube

Cat. No.	Dimensions (In Inches)		
	A Thd. Size	B	Tube Dia.
253007	1/16-20 UNF	.890	.250
253008	1/16-18 UNF	1.060	.375

Female Tee
NPTF

Cat. No.	Dimensions (In Inches)	
	A Thd. Size	B
252998	1/4 NPTF	.890

90° Male Elbow
37° Flared Tube to NPTF

Cat. No.	Dimensions (In Inches)				
	A Thd. Size	B Thd. Size	C	D	Tube Dia.
253009	1/16-20 UNF	1/4 NPTF	1.060	1.090	.250
253010	1/16-18 UNF	3/8 NPTF	1.140	1.220	.375
253175	1/16-20 UNF	1/2 NPTF	.890	.780	.250

Male Run Tee
37° Flared Tube to NPTF

Cat. No.	Dimensions (In Inches)				
	A Thd. Size	B Thd. Size	C	D	Tube Dia.
253022	1/16-20 UNF	1/8 NPTF	.890	.780	.250
253023	1/16-20 UNF	1/4 NPTF	1.060	1.090	
253025	1/16-18 UNF	3/8 NPTF	1.140	1.220	.375
253026		1/2 NPTF			

90° Male Elbow
37° Flared Tube to O.R.B.

Cat. No.	Dimensions (In Inches)					
	A Thd. Size	B Thd. Size	C	D	E Hex.	Tube Dia.
250605	1/16-20 UNF	1/16-20 UNF SAE-4	.890	1.030	.562	.250
253011		1/16-18 UNF SAE-6	1.060	1.250	.687	
253012	1/16-18 UNF	3/16-16 UNF SAE-8	1.140	1.450	.875	.375
253013		1/8-14 UNF SAE-10	1.230	1.700	1.000	

Male Run Tee
37° Flared Tube to O.R.B.

Cat. No.	Dimensions (In Inches)					
	A Thd. Size	B Thd. Size	C	D	E Hex.	Tube Dia.
253024	1/16-20 UNF	1/16-20 UNF SAE-4	.890	1.030	.562	.250
253027	1/16-18 UNF	1/16-18 UNF SAE-6	1.060	1.250	.687	.375

Male Tee
37° Flared Tube

Cat. No.	Dimensions (In Inches)		
	A Thd. Size	B	Tube Dia.
252996	1/16-20 UNF	.890	.250
252997	1/16-18 UNF	1.060	.375

Male Branch Tee
37° Flared Tube to NPTF

Cat. No.	Dimensions (In Inches)				
	A Thd. Size	B Thd. Size	C	D	Tube Dia.
253028	1/16-20 UNF	1/8 NPTF	.890	.780	.250
253030	1/16-18 UNF	1/4 NPTF	1.060	1.090	.375

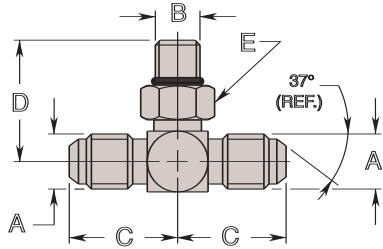

Male Branch Tee
37° Flared Tube to O.R.B.

Cat. No.	Dimensions (In Inches)					
	A Thd. Size	B Thd. Size	C	D	E Hex.	Tube Dia.
253029	1/16"-20 UNF	1/16"-20 UNF SAE-4	.890	1.030	.562	.250
253031	1/16"-18 UNF	1/16"-18 UNF SAE-6	1.060	1.250	.687	.375

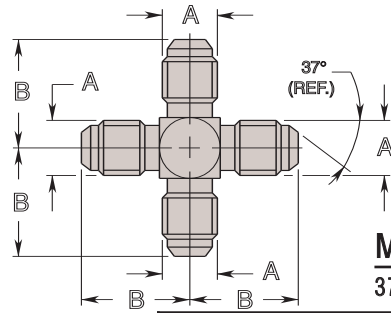

Male Cross
37° Flared Tube

Cat. No.	Dimensions (In Inches)		
	A Thd. Size	B	Tube Dia.
252999	1/16"-20 UNF	.890	.250
253000	1/16"-18 UNF	1.060	.375

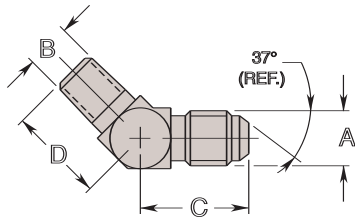

Male 45° Elbow
37° Flared Tube to NPTF

Cat. No.	Dimensions (In Inches)				
	A Thd. Size	B Thd. Size	C	D	Tube Dia.
253014	1/16"-20 UNF	1/4" NPTF	.820	.860	.250
253016	1/16"-18 UNF	1/4" NPTF	.840	.860	.375
253017	1/16"-18 UNF	3/8" NPTF	.880	.950	.375

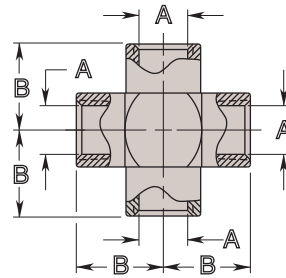

Female Cross
NPTF

Cat. No.	Dimensions (In Inches)	
	A Thd. Size	B
253001	1/4" NPTF	.890

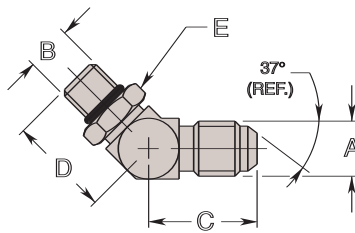

Male 45° Elbow
37° Flared Tube to O.R.B.

Cat. No.	Dimensions (In Inches)					
	A Thd. Size	B Thd. Size	C	D	E Hex.	Tube Dia.
253015	1/16"-20 UNF	1/16"-20 UNF SAE-4	.720	1.050	.562	.250
253018	1/16"-18 UNF	1/16"-18 UNF SAE-6	.830	1.180	.687	.375

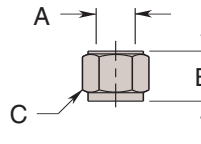

Nut
37° Flared Tube

Cat. No.	Dimensions (In Inches)			
	A Thd. Size	B	C Hex.	Tube Dia.
253032	1/16"-20 UNF	.610	.562	.250
253033	1/16"-18 UNF	.720	.687	.375

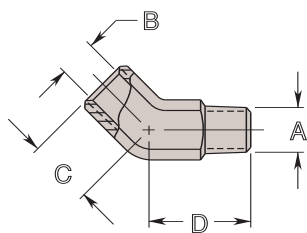

45° Elbow Adapter
NPTF

Cat. No.	Dimensions (In Inches)			
	A Thd. Size	B Thd. Size	C	D
19121	1/8" NPTF	1/8" NPTF	.470	.720
10645	1/4" NPTF	1/4" NPTF	.630	1.050

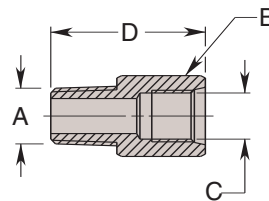

Straight
BSPF to O.R.B.

Cat. No.	Dimensions (In Inches)			
	A Thd. Size	B Hex.	C	D
253288	1/4" BSPF	.750	1/16"-20 UNF SAE-4	1.250

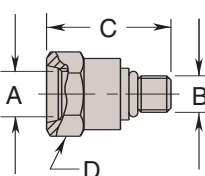

Straight
O.R.B.

Cat. No.	Dimensions (In Inches)			
	A Thd. Size	B Thd. Size	C	D Hex.
351816	1/16"-20 UNF SAE-4	1/16"-24 UNC SAE-2	1.065	.625