

**DOUBLE-ACTING, TWIN ROD  
HYDRAULIC CYLINDER**  
Max. Capacity: 100 Tons at 10,395 PSI

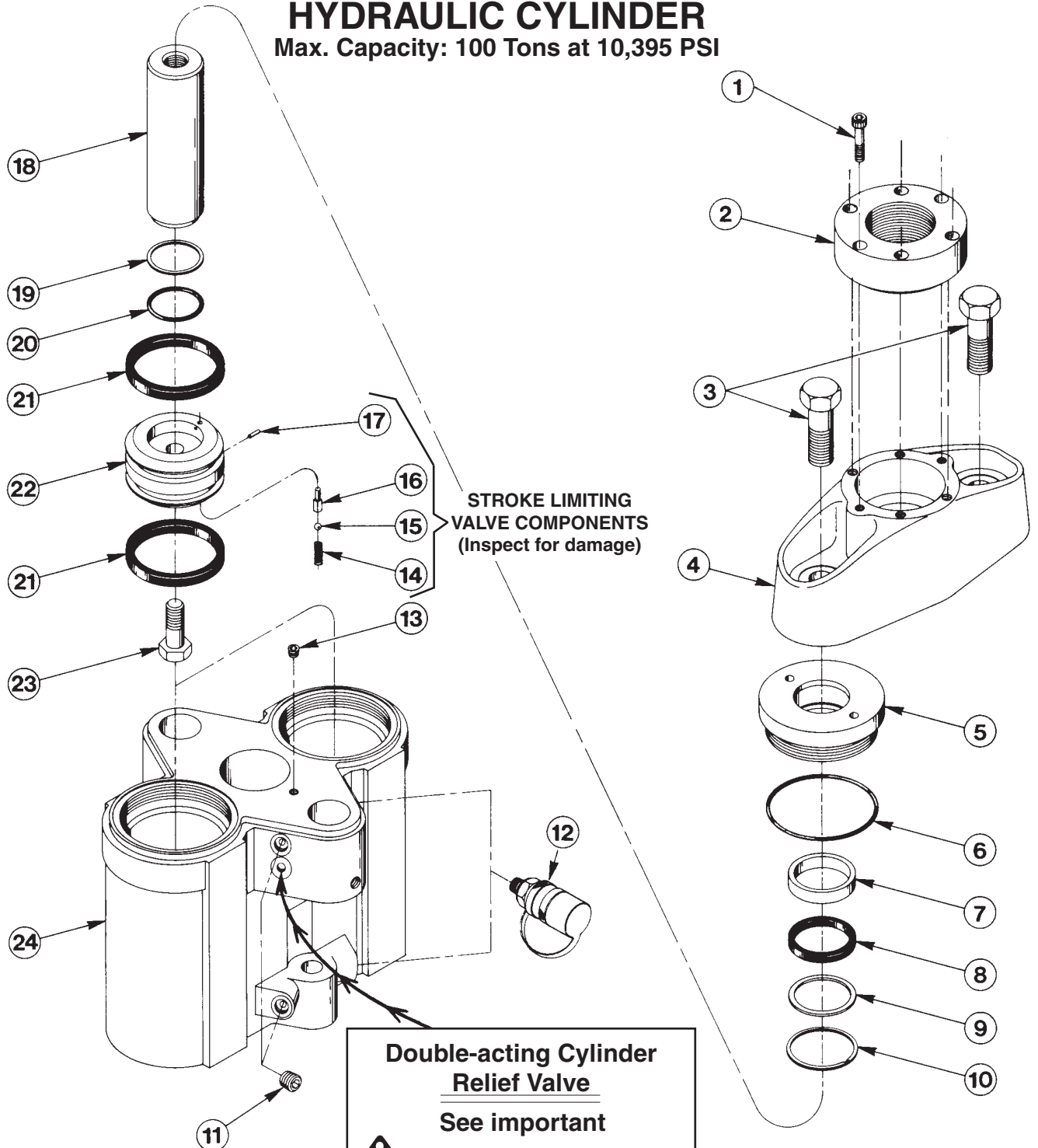

STROKE LIMITING  
VALVE COMPONENTS  
(Inspect for damage)

**Double-acting Cylinder  
Relief Valve**  
See important  
**⚠ DANGER** statement  
on back of sheet 1 of 1



**DANGER:** To help avoid possible serious personal injury or death,

- In the event that the cylinder retract port is ever restricted or plugged, a double-acting cylinder relief valve will help prevent excessive pressure from building in the cylinder. **DO NOT** attempt to adjust or service this relief valve! If oil leakage is detected from this relief valve, discontinue use of the cylinder immediately and contact Power Team Technical Services. Only Power Team Authorized Hydraulic Service Centers should service this relief valve.
- Sudden movement of the piston rod(s) near the end of stroke may damage the plunger and interfere with it's ability to limit the stroke of this cylinder. A qualified person should inspect the plunger (#24199) and the spring (#11221) for damage and replace as necessary.

Item No.	Part No.	No. Req'd	Description
1	10948	6	Soc. Hd. Cap Screw (5/16-18 UNC x 1-1/2 Lg.)
2	24197	1	Tapped Insert
3	11293	2	Hex. Hd. Cap Screw (7/8-14 UNF x 2-1/2 Lg.; Torque to 50 ft. lbs.)
4	40536	1	Piston Coupling Head
5	43582	2	Cylinder Cap (Torque to 200 ft. lbs.)
6	*10298	2	O-ring (4-1/8 x 3-7/8 x 1/8)
7	*200145	2	Bearing
8	*15232	2	U-cup
9	*200146	2	Retainer
10	12115	2	Retaining Ring (for 2-3/8 shaft)
11	10909	2	Pipe Plug (3/8 NPTF)
12	9796	2	Ram Half Coupler
13	10427	1	Pipe Plug (1/8 NPTF)
14	11221	2	Compression Spring (1/4 O.D. x 1" Lg.)
15	10375	2	Steel Ball (1/4 dia.)
16	24199	2	Plunger (Stroke limiting)
17	11512	2	Roll Pin (3/32 dia. x 7/16 Lg.)
18	31901	2	Piston Rod
19	*19145	2	Backup Washer
20	*10294	2	O-ring (2" x 1-3/4 x 1/8)
21	*11517	4	U-cup
22	31890	2	Piston Head
23	12059	2	Hex. Hd. Cap Screw (5/8-18 UNF x 1-3/4 Lg.; Torque to 50 ft. lbs.)
24	60632	1	Ram Body

**PARTS INCLUDED BUT NOT SHOWN**

*12980	1	Warning Decal
*203908	1	Warning Decal
252123	1	Decal

Part numbers marked with an asterisk (\*) are contained in Repair Kit No. 300024.

Refer to any operating instructions included with this product for detailed information about operation, testing, disassembly, reassembly, and preventive maintenance.

Items found in this parts list have been carefully tested and selected. **Therefore: Use only genuine Power Team replacement parts!**

Additional questions can be directed to our Technical Services Department.