

DOUBLE-ACTING, HOLLOW CENTER HYDRAULIC CYLINDER

Max. Capacity: 100.1 Tons at 10,000 PSI (Push)
 54.7 Tons at 10,000 PSI (Pull)

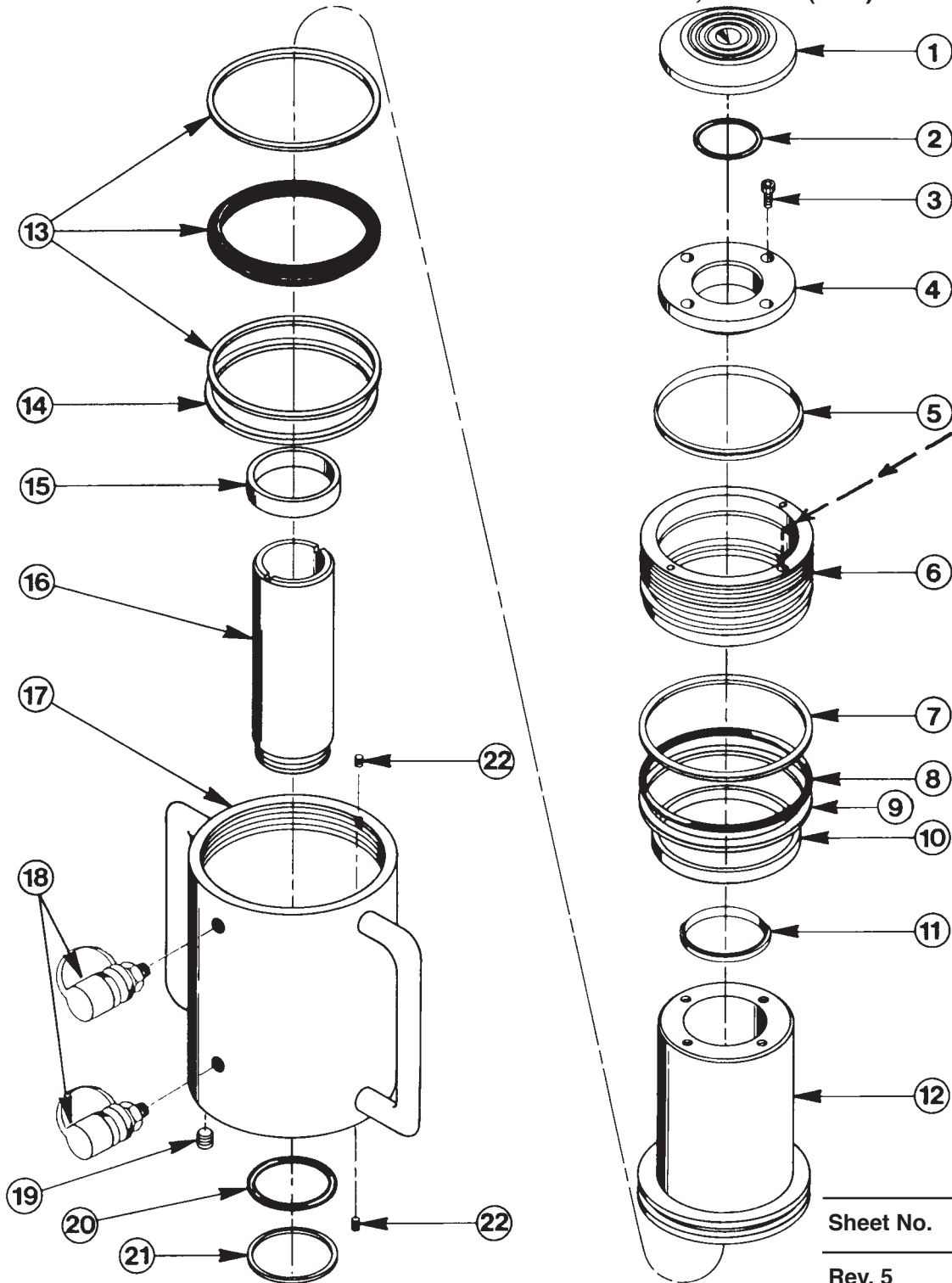

Double-acting
 Cylinder
 Relief Valve

See important
! DANGER
 statement
 on back of
 sheet 1 of 1

⚠ DANGER: To help avoid possible serious personal injury or death,
 ● In the event that the cylinder retract port is ever restricted or plugged, a double-acting cylinder relief valve will help prevent excessive pressure from building in the cylinder. **DO NOT** attempt to adjust or service this relief valve! If oil leakage is detected from this relief valve, discontinue use of the cylinder immediately and contact Power Team Technical Services. Only Power Team Authorized Hydraulic Service Centers should service this relief valve.

| Item No. | Part No. | No. Req'd | Description |
|----------|----------|-----------|--|
| 1 | 38300 | 1 | Serrated Insert |
| 2 | *10294 | 1 | O-ring (2" x 1-3/4 x 1/8) |
| | †11447 | 1 | O-ring (2" x 1-3/4 x 1/8) |
| 3 | 10006 | 4 | Soc. Hd. Cap Screw (1/4-20 x 5/8 Lg.; Torque to 140-160 in. lbs.) |
| 4 | 38301 | 1 | End Cap |
| 5 | *207608 | 1 | Rod Wiper |
| | †206126 | 1 | Rod Wiper |
| 6 | 51270 | 1 | Retainer Nut |
| 7 | †*19175 | 1 | PTFE Backup Washer |
| 8 | *17480 | 1 | O-ring (6" x 5-3/4 x 1/8) |
| | †206867 | 1 | O-ring (6" x 5-3/4 x 1/8) |
| 9 | †206813 | 1 | PTFE Backup Washer |
| 10 | *18932 | 1 | U-cup (4-3/4 x 4-3/8 x 3/8) |
| | †206147 | 1 | U-cup (4-3/4 x 4-3/8 x 1/16) |
| 11 | *18931 | 1 | Rod Wiper |
| | †206124 | 1 | Rod Wiper |
| 12 | 51269 | 1 | Piston |
| 13 | *18934 | 1 | T-seal (Piston) & Backup Rings (Smooth side of Backup Ring must be against seal.) |
| | †19247 | 1 | T-seal (Piston) & Backup Rings (Smooth side of Backup Ring must be against seal.) |
| 14 | †206812 | 1 | PTFE Backup Washer (2-3/4) |
| 15 | *18933 | 1 | U-cup (3-1/4 x 2-3/4 x 3/8) |
| | †206148 | 1 | U-cup (3-1/4 x 2-3/4 x 1/4) |
| 16 | 38299 | 1 | Stand Pipe |
| 17 | 60537 | 1 | Cylinder Body Assembly |
| 18 | 25600 | 2 | Ram Half Quick Coupler |
| 19 | 18929 | 4 | Set Screw (1/2-13 x 1/2 Lg.) |
| 20 | *10296 | 1 | O-ring (3" x 2-3/4 x 1/8) |
| | †206866 | 1 | O-ring (3" x 2-3/4 x 1/8) |
| 21 | †*19163 | 1 | PTFE Backup Washer |
| 22 | 10556 | 2 | Set Screw (1/4-20 x 1/4 Lg.; For locking Stand Pipe [Item #16] and Retainer Nut [Item #6] in place.) |

PARTS INCLUDED BUT NOT SHOWN

| | | |
|---------|---|--------------------------------------|
| *37782 | 1 | Warning Decal (For RH1006) |
| 204488 | 1 | Trade Name Decal (For RH1006) |
| †19526 | 2 | O-ring (For coupler; 1" x 3/4 x 1/8) |
| †205724 | 1 | Decal (Viton) |

Part numbers marked with an asterisk (*) are contained in Standard Repair Kit No. 300295.
 Part numbers marked with a dagger (†) are contained in Viton Seal Kit No. 300227.

Refer to any operating instructions included with this product for detailed information about operation, testing, disassembly, reassembly, and preventive maintenance.

Items found in this list have been carefully tested and selected. **Therefore: Use only genuine Power Team replacement parts!**

Additional questions can be directed to our Technical Services Department.