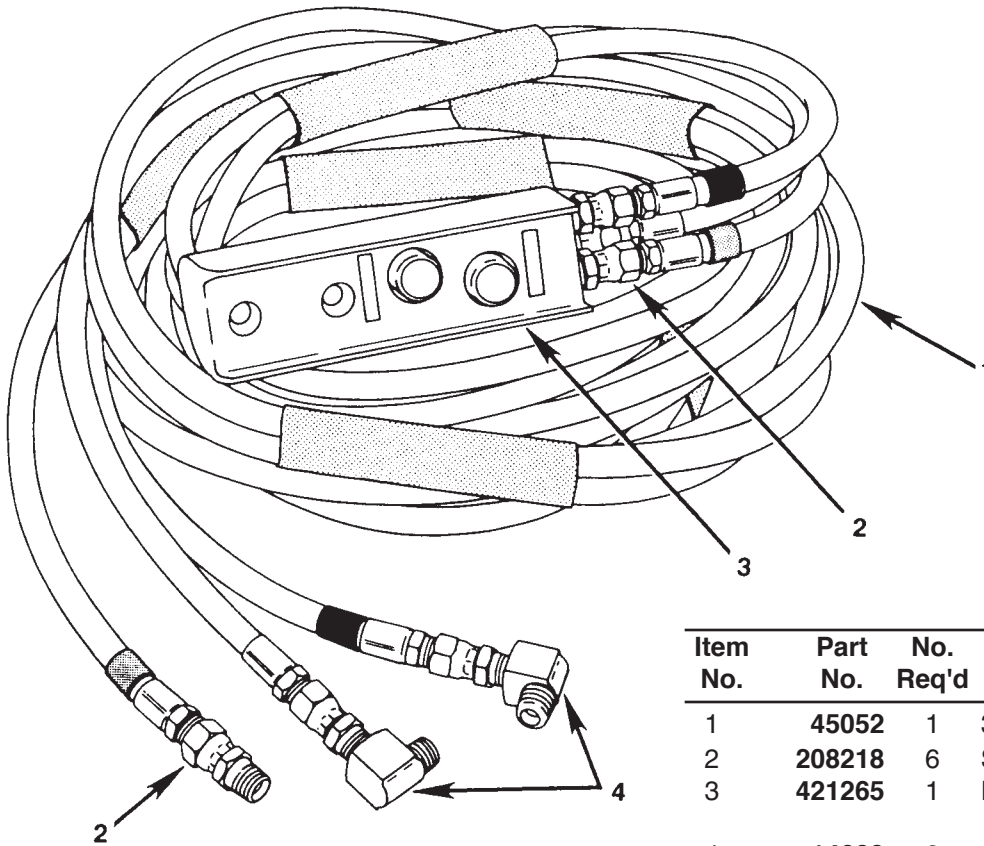

## Parts List for:

209593  
PA55A4**AIR OPERATED REMOTE HAND CONTROL**

Item No.	Part No.	No. Req'd	Description
1	45052	1	3 Strand Hose Assembly
2	208218	6	Swivel Fitting
3	421265	1	Remote Hand Control (See Form No. 100426)
4	14680	2	90° Elbow Fitting

**AIR CONNECTIONS:**

**IMPORTANT:** Seal all air connections with a high quality, nonhardening pipe thread sealant.. PTFE tape may also be used to seal connections, provided only one layer is used. Apply the tape carefully, two threads back, to prevent it from being pinched by the fitting and broken off inside the system. Any loose pieces of tape could travel through the system and obstruct the flow of air or cause jamming of precision-fit parts.

**NOTE:** When either the RETRACT or the ADVANCE buttons are released, air is vented to the atmosphere.

- Note that the male fittings of the hose are either stamped with the numbers "1", "2", or "3" or they are identified by color on each end. Connect the hoses to the remote hand control by matching the numbers stamped on the hoses to the hoses to the corresponding numbers stamped near the inlets of the remote hand control. See Figure 1.
- Connect the other end of the color-coded hose from the hand control air supply port (port #2) to an air supply. Connect the color-coded hose from the retract port (port #1) to the retract port of the valve. Connect the color-coded hose from the advance port (port #3) to the advance port of the valve.

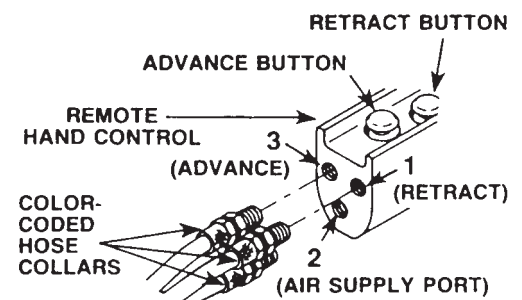

FIGURE 1

Note: Shaded areas reflect last revision(s) made to this form.

Sheet No. 1 of 1

Rev. 2 Date: 25 May 2012