

DOUBLE-ACTING, HOLLOW CENTER HYDRAULIC CYLINDER

Max. Capacity: 400 Tons at 10,185 PSI

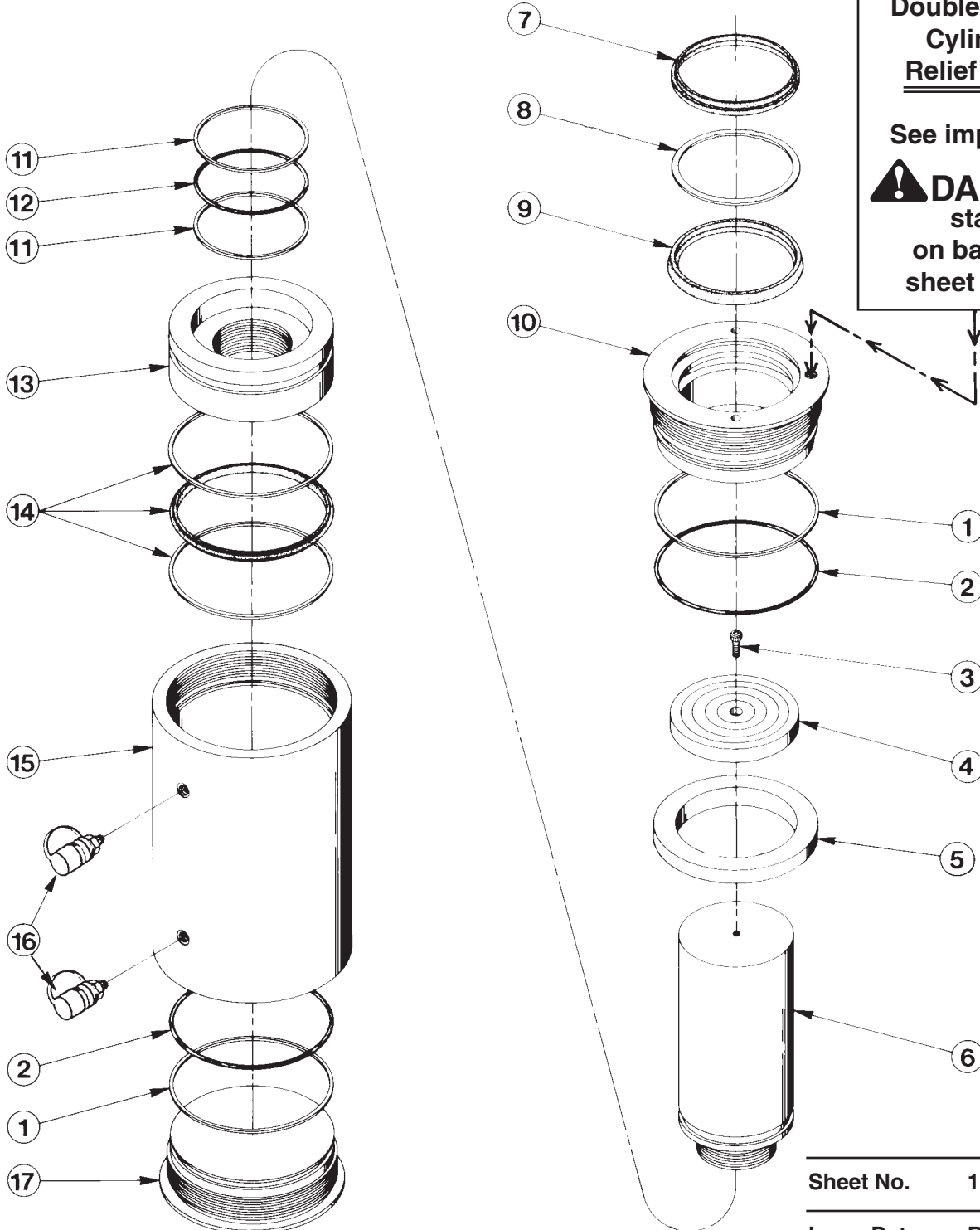

Double-acting
Cylinder
Relief Valve

See important
! DANGER
statement
on back of
sheet 1 of 1

 **DANGER:** To help avoid possible serious personal injury or death,

- In the event that the cylinder retract port is ever restricted or plugged, a double-acting cylinder relief valve will help prevent excessive pressure from building in the cylinder. **DO NOT** attempt to adjust or service this relief valve! If oil leakage is detected from this relief valve, discontinue use of the cylinder immediately and contact **Power Team Technical Services**. Only Power Team Authorized Hydraulic Service Centers should service this relief valve.

Item No.	Part No.	No. Req'd	Description
1	*212680	2	Backup Washer (10" x 9-1/2 x .095)
2	*212682	2	O-ring (10" x 9-1/2 x 1/4, -448)
3	10050	1	Cap Screw (3/8-16 UNC x 1" Lg.)
4	46373	1	Piston Rod Cap
5	47366	1	Spacer (for RD40066)
6	†52721-6	1	Piston Rod (6" stroke, for RD4006)
	†52721-13	1	Piston Rod (13" stroke, for RD40013)
	†52721-42	1	Piston Rod (42" stroke, for RD40042)
	†52721-66	1	Piston Rod (66" stroke, for RD40066)
7	*212686	1	Rod Wiper
8	*212685	1	Backup Washer (8" x 7-1/4 x 1/8)
9	*212684	1	U-cup
10	61419	1	Piston Retainer (Torque to 1000 ft. lbs.)
11	*212679	2	Backup Washer (7-1/4 x 6-3/4 x .095)
12	*212683	1	O-ring (7-1/4 x 6-3/4 x 1/4, -440)
13	52720	1	Piston Head
14	*212681	1	T-seal and Backup Rings
15	†61425-6	1	Cylinder Body (6" stroke, for RD4006)
	†61425-13	1	Cylinder Body (13" stroke, for RD40013)
	†61425-42	1	Cylinder Body (42" stroke, for RD40042)
	†61425-66	1	Cylinder Body (66" stroke, for RD40066)
16	25600	2	Quick Coupler
17	52719	1	Retainer Nut (Torque to 1000 ft. lbs.)

PARTS INCLUDED BUT NOT SHOWN

37782	1	Warning Decal
306569	1	Trade Name Decal
52724	1	Handle Assembly (for RD4006 & RD40013)
58264	2	Handle Assembly (for RD40042)
52724	2	Handle Assembly (for RD40066)

Part numbers marked with an asterisk (*) are contained in Repair Kit No. 300467.

† For special stroke lengths, list stroke as suffix to part number:
 52721 - (6", 13", 42", or 66" stroke) Piston Rod
 61425 - (6", 13", 42", or 66" stroke) Cylinder Body

Refer to any operating instructions included with this product for detailed information about operation, testing, disassembly, reassembly, and preventive maintenance.

Items found in this parts list have carefully tested and selected. **Therefore: Use only genuine Power Team replacement parts!**

Additional questions can be directed to our Technical Services Department.