

**DOUBLE-ACTING
HYDRAULIC CYLINDER**
Max. Capacity: 500 Tons at 10,000 PS

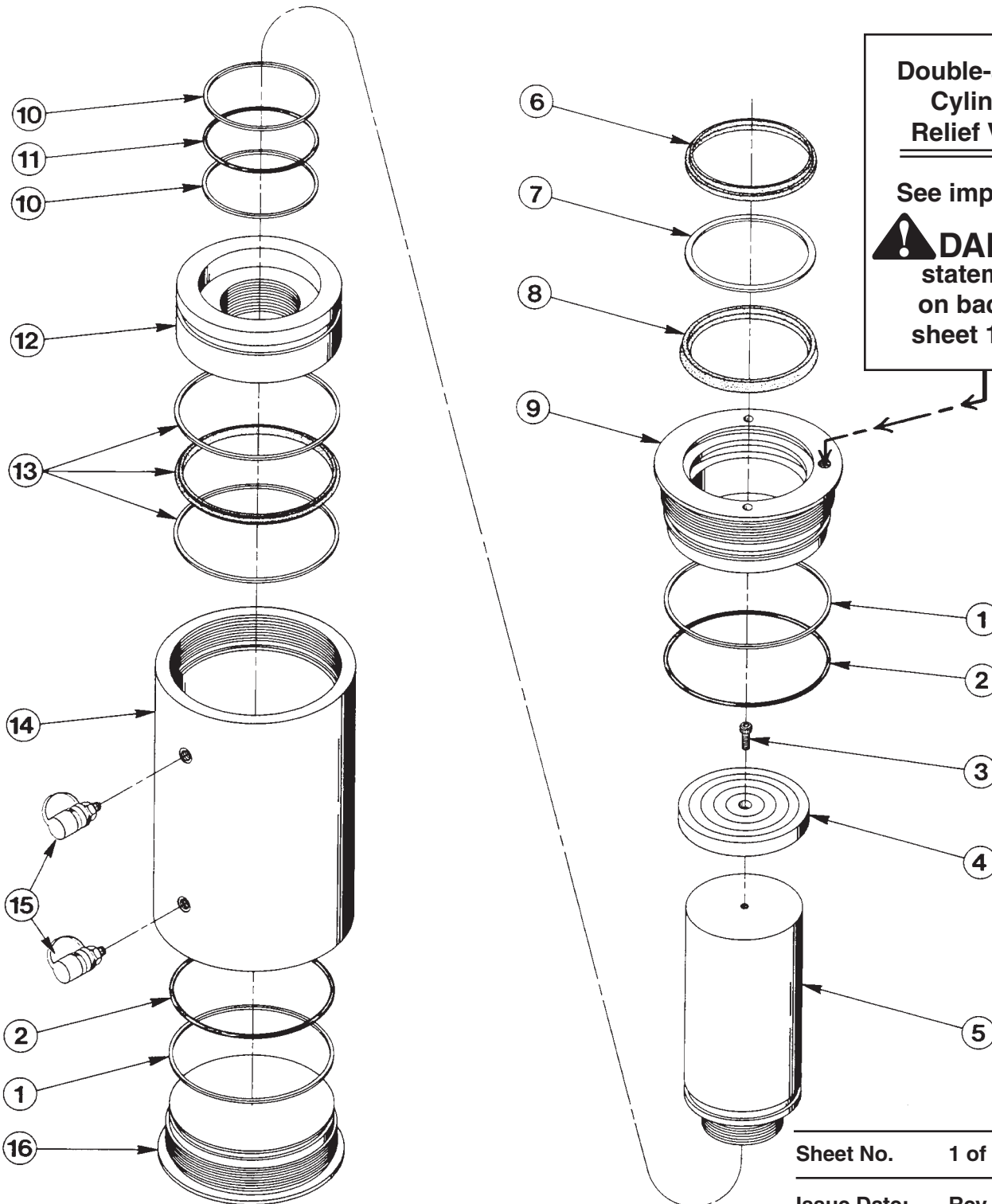

**Double-acting
Cylinder
Relief Valve**

See important
DANGER
statement
on back of
sheet 1 of 1

 **DANGER:** To help avoid possible serious personal injury or death,

- In the event that the cylinder retract port is ever restricted or plugged, a double-acting cylinder relief valve will help prevent excessive pressure from building in the cylinder. **DO NOT** attempt to adjust or service this relief valve! If oil leakage is detected from this relief valve, discontinue use of the cylinder immediately and contact **Power Team Technical Services**. Only Power Team Authorized Hydraulic Service Centers should service this relief valve.

Item No.	Part No.	No. Req'd	Description
1	*212708	2	Backup Washer (11" X 10-1/2 X .095, -450)
2	*212711	2	O-ring (11-1/4 X 10-3/4 X 1/4, special)
3	10050	1	Cap Screw (3/8-16 X 1" Lg.)
4	52736	1	Piston Rod Cap
†5	52732-6	1	Piston Rod (6" stroke, for RD5006)
	52732-13	1	Piston Rod (13" stroke for RD50013)
6	*212715	1	Rod Wiper
7	*212714	1	Backup Washer (9" X 8" X .496)
8	*212713	1	U-cup
9	61437	1	Piston Retainer (Torque to 1000 ft. lbs.)
10	*212709	2	Backup Washer (8" X 7-1/2 X .095, -443)
11	*212712	1	O-ring (8" X 7-1/2 X 1/4, -443)
12	52734	1	Piston Head
13	*212710	1	T-Seal & Backup Rings
†14	61433-6	1	Cylinder Body (6" stroke for RD5006)
	61433-13	1	Cylinder Body (13" stroke for RD50013)
15	9796	2	Ram Half Coupler w/Dust Cap
16	52735	1	Retainer Nut (Torque to 650 ft. lbs.)

PARTS INCLUDED BUT NOT SHOWN

37782	1	Warning Decal
306571	1	Trade Name Decal
52725	1	Handle Assembly
420900	1	Spacer (For stroke lengths from 32" thru 48")

Part numbers marked with an (*) asterisk are contained in Repair Kit No. 300468.

†For special stroke lengths, list stroke as suffix to part number:

52732 - " " Piston Rod
61433 - " " Cylinder Body

Refer to any operating instructions included with this product for detailed information about operation, testing, disassembly, reassembly, and preventive maintenance.

Items found in this parts list have been carefully tested and selected. **Therefore: Use only genuine Power Team replacement parts!**

Additional questions can be directed to our Technical Services Department.

Note: Shaded areas reflect last revision(s) made to this form.