

Parts List and  
Assembly Instructions for:

420866	420869
420867	420870
420868	420871

## TILT SADDLE CAP ASSEMBLY

FOR R 55, 100, 150, 200, 280, 355, 430, AND 565 TON CYLINDERS

### #420866 for R 55 & 100 Ton Series

Item No.	Part No.	No. Req'd	Description
1	251553	1	Hex. Soc. Flat Hd. Screw
4	420864-55	1	Swivel Cap
5	420865-55	1	Tilt Saddle Base

### #420867 for R 150 & 200 Ton Series

Item No.	Part No.	No. Req'd	Description
1	251554	1	Hex. Soc. Flat Hd. Screw
2	12004	1	Washer (For 1/2" bolt)
4	420864-150	1	Swivel Cap
5	420865-150	1	Tilt Saddle Base

### #420868 for R 280 Ton Series

Item No.	Part No.	No. Req'd	Description
1	251555	1	Hex. Soc. Flat Hd. Screw
2	12004	1	Washer (For 1/2" bolt)
4	420864-280	1	Swivel Cap
5	420865-280	1	Tilt Saddle Base

### #420869 for R 355 Ton Series

Item No.	Part No.	No. Req'd	Description
1	251556	1	Hex. Soc. Flat Hd. Screw
2	12004	1	Washer (For 1/2" bolt)
3	10236	1	Washer (For 3/4" bolt)
4	420864-355	1	Swivel Cap
5	420865-355	1	Tilt Saddle Base

### #420870 for R 430 Ton Series

Item No.	Part No.	No. Req'd	Description
1	251556	1	Hex. Soc. Flat Hd. Screw
2	12004	1	Washer (For 1/2" bolt)
3	10236	1	Washer (For 3/4" bolt)
4	420864-430	1	Swivel Cap
5	420865-430	1	Tilt Saddle Base

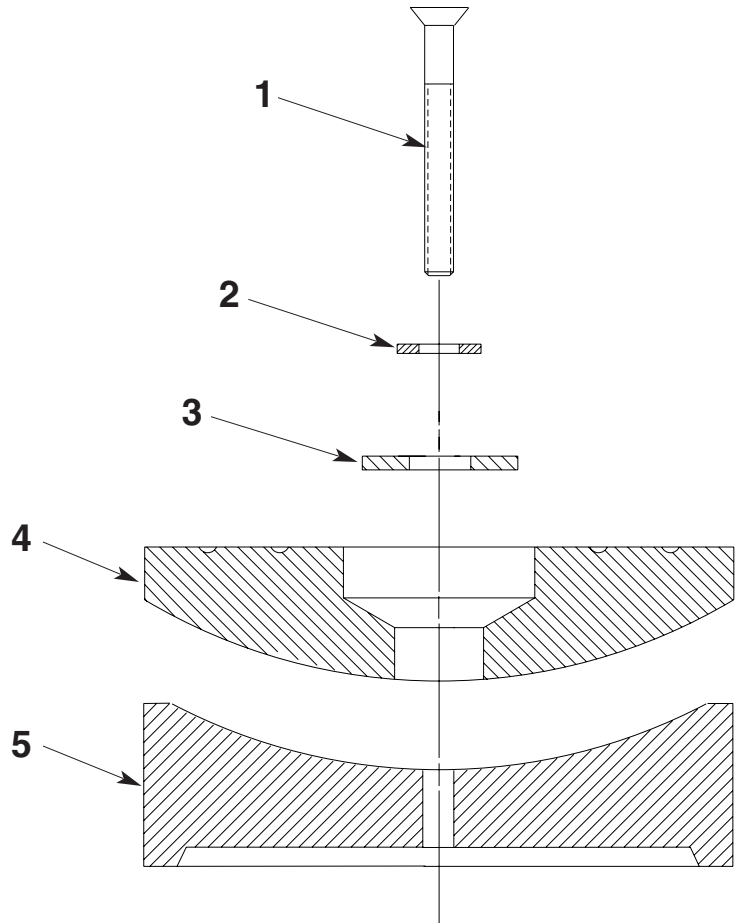

### #420871 for R 565 Ton Series

Item No.	Part No.	No. Req'd	Description
1	250969	1	Hex. Soc. Flat Hd. Screw
2	12004	1	Washer (For 1/2" bolt)
3	10236	1	Washer (For 3/4" bolt)
4	420864-565	1	Swivel Cap
5	420865-565	1	Tilt Saddle Base

## **ASSEMBLY INSTRUCTIONS**

1. Mount tilt saddle base and cap to cylinder piston with appropriate self-locking hex. socket flat head screw (and washer[s] if required).
2. Tilt swivel cap until bottom of swivel cap contacts the screw.
3. Thread in self-locking flat head screw while holding cap tilted against screw. Turn in screw as far as possible or until screw head begins to pull down on cap. Swivel cap should swivel freely.